

Flanged LDMOST ceramic package; 2 mounting holes; 4 leads

SOT979A

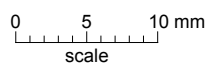
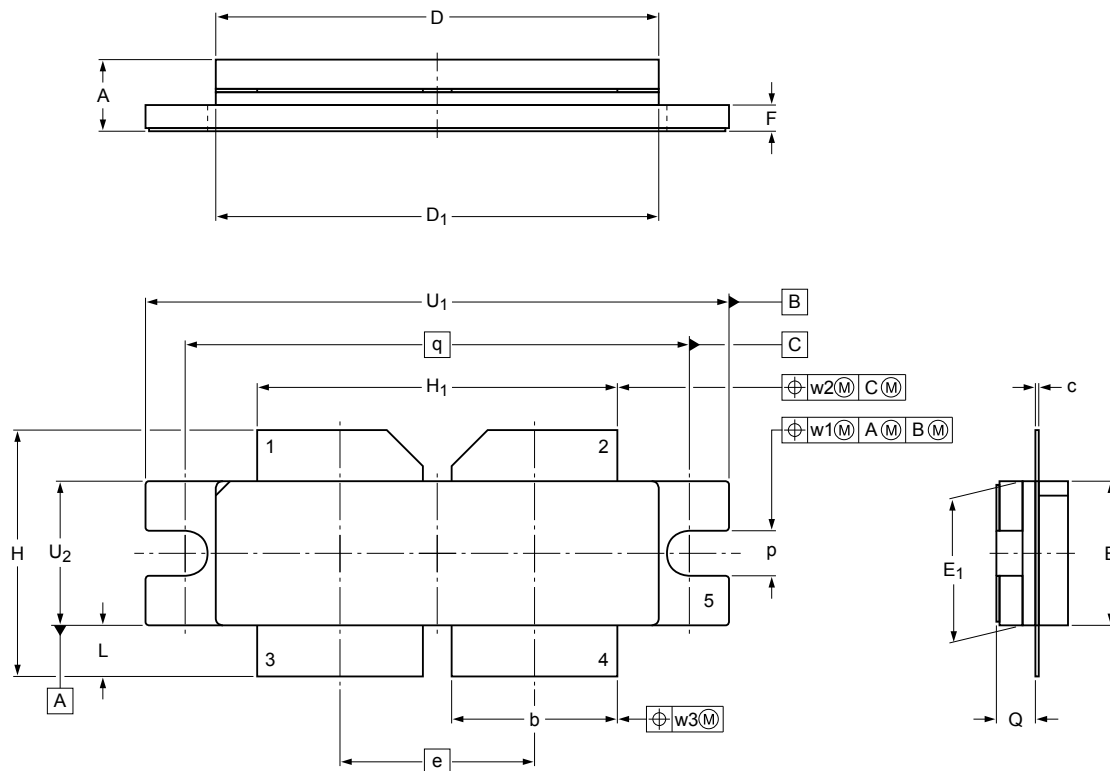

w₃
0.25
0.010

Dimensions

Unit ⁽¹⁾	A	b	c	D	D ₁	E	E ₁	e	F	H	H ₁	L	p	Q	q	U ₁	U ₂	w ₁	w ₂
mm	max	5.77	11.81	0.15	31.55	31.37	10.29	10.29	1.969	17.50	25.53	3.86	3.30	3.02	35.56	41.28	10.29	0.25	0.51
	min	4.80	11.56	0.10	30.94	31.12	10.03	10.03	1.689	17.25	25.27	3.35	3.05	2.77		41.02	10.03		
inches	max	0.227	0.465	0.006	1.242	1.235	0.405	0.405	0.078	0.689	1.005	0.152	0.130	0.119	1.400	1.625	0.405	0.010	0.020
	min	0.189	0.455	0.004	1.218	1.225	0.395	0.395	0.067	0.679	0.995	0.132	0.120	0.109		1.615	0.395		

Note

1. millimeter dimensions are derived from the original inch dimensions.

sot979a_po

Outline version	References			European projection	Issue date
	IEC	JEDEC	JEITA		
SOT979A					08-04-24 08-09-04