

Earless flanged ceramic package; 2 leads

SOT502C

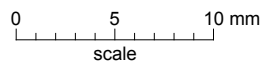
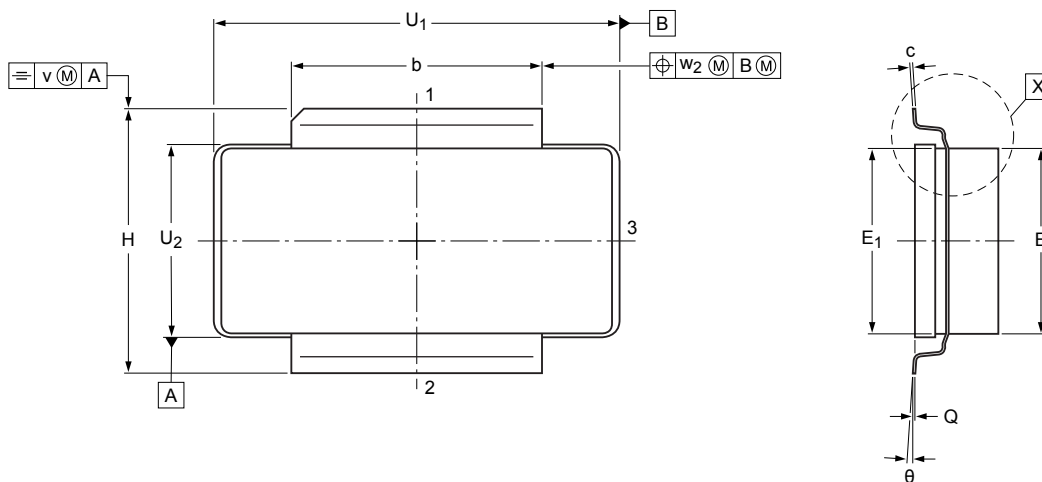
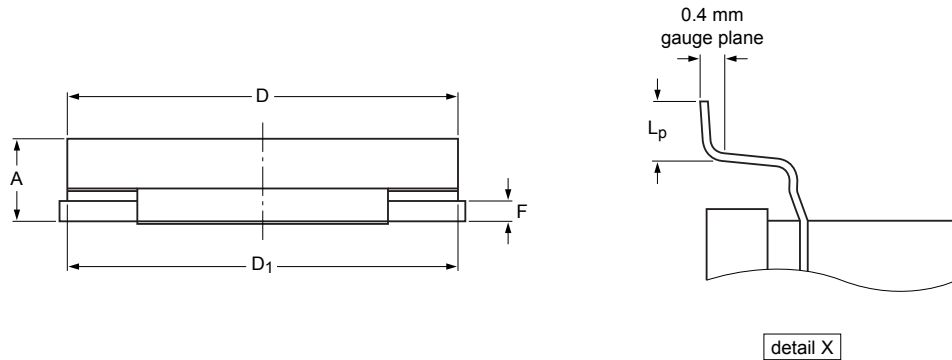

Dimensions

Unit ⁽¹⁾	A	b	c	D	D ₁	E	E ₁	F	H	L _p	Q	U ₁	U ₂	v	w ₂	θ	
mm	max	4.72	12.83	0.16	20.02	19.96	9.53	9.53	1.14	13.6	1.2	0.195	20.70	9.91	0.25	0.25	7°
	nom																
inches	max	0.185	0.505	0.006	0.788	0.786	0.375	0.375	0.045	0.536	0.048	0.008	0.815	0.39	0.01	0.01	7°
	nom																

Note

1. Millimeter dimensions are derived from the original inch dimensions.

sot502c_po

Outline version	References			European projection	Issue date
	IEC	JEDEC	JEITA		
SOT502C					11-05-02 12-05-02